

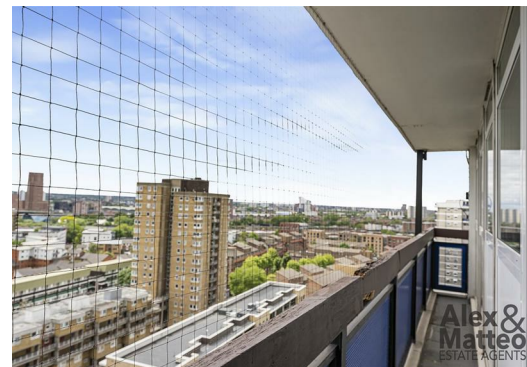

Alex & Matteo
ESTATE AGENTS



Rotherhithe New Road, London, SE16 2PU

A unique top floor (15th floor) two double bedroom apartment enjoying stunning views, located moments from Southwark Park and within walking distance from both Canada Water and Surrey Quays Stations. The apartment features a tidy kitchen space, generous living room with space to dine and access to a private balcony, two generous double bedrooms with built-in storage, and family bathroom, as well as additional hallway storage.

The property is conveniently located near many local amenities such as local restaurants, cafes, shopping centre, supermarket, leisure centre, and the greenery of Southwark Park. Our clients are looking for a hassle free completion: only Cash Buyers will be considered.

Years on Lease - 89
Annual Ground Rent - £10
Annual Service Charge - £2795.01
Council Tax Band - B

Council tax, property size and, where applicable, lease information, service charges and ground rent are given as a guide only and should always be checked and confirmed by your Solicitor prior to exchange of contracts.

- Top Floor Two Bedroom Apartment
- Stunning Views
- Chain Free
- Large Private Balcony
- Exclusive Deal For Cash Buyers
- Excellent Transport Links (Jubilee Line and Overground)
- Great Location
- Next To Southwark Park
- Moments from Canada Water Masterplan

£250,000

Alex & Matteo
ESTATE AGENTS

Brydale House, Rotherhithe New Road London, SE16 2PU

Approximate Area = 669 sq ft / 62.1 sq m

(Excluding Balcony)

For identification only - Not To Scale

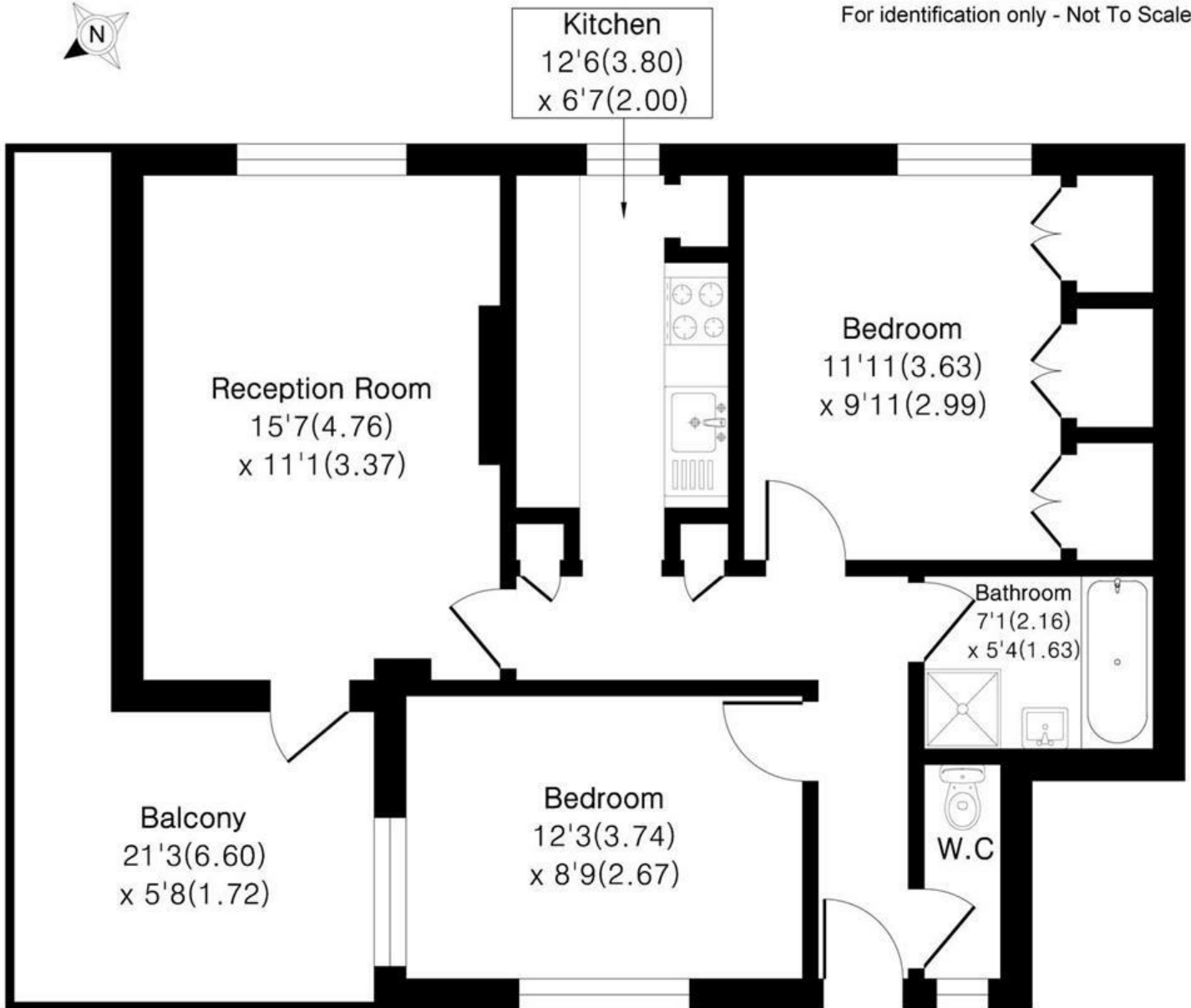

15th Floor



Floor plan Produced in accordance with RICS Property Measurement 2nd Edition.
Incorporating International Property Measurement Standards (IPMS2 Residential).
Produced for Alex & Matteo Estate Agents.

